



## Setup Instructions



### Noah Interface

mono Scan ■ duo Scan ■ duo Scan Touch ■ free Stage ■  
ds Production

Products from smart optics Sensortechnik GmbH



## Legal Notice

### Support

For direct customers and reseller: [support@smartoptics.de](mailto:support@smartoptics.de)

For customers of reseller:..... (Your reseller)

Search for reseller:

Use the [www.smartoptics.de](http://www.smartoptics.de) contact form.

### smart optics Audiology Online Shop

Delivery within the EU: [smartoptics.shop/en/](http://smartoptics.shop/en/)

Delivery outside the EU: [onlineshop@smartoptics.de](mailto:onlineshop@smartoptics.de)

### Changes

smart optics reserves the right to make changes in the products and this documentation.

For the current version of this documentation visit: [www.smartoptics.de](http://www.smartoptics.de).

### Brands and Trademarks

FlyCapture	Point Grey Research, Inc.
UpdaterGUI	
IPRO	IPRO GmbH, DE-71229 Leonberg
Noah	HIMSA II K/S, Copenhagen, (Denmark), Minneapolis (USA)
HIMSA	
PYLON	Basler AG, DE-22926 Ahrensburg
Windows	Microsoft Corporation, Redmond (Washington, USA)
.NET Framework	
Visual C++	

Royalty-free icons and illustrations from the image agencies Flaticon.com, Fotolia.com, Freepik.com and Pixabay.com are used in this operating manual.

## Table of contents

<b>1</b>	<b>About this manual.....</b>	<b>4</b>
<b>2</b>	<b>smart optics interface with Noah.....</b>	<b>7</b>
2.1	Introduction.....	7
2.2	About the interface.....	7
2.3	About Noah.....	8
2.4	Prerequisites .....	9
2.4.1	Qualification .....	9
2.4.2	Rights, licences, hardware .....	9
2.4.3	Software compatibility .....	10
<b>3</b>	<b>System configuration examples .....</b>	<b>11</b>
<b>4</b>	<b>Set up the Noah server .....</b>	<b>13</b>
4.1	Overview .....	13
4.2	Install the scanning software .....	13
4.3	Share the scan data folder as a network path.....	13
4.3.1	Folder sharing (part 1: sharing) .....	14
4.3.2	Folder sharing (part 2: security).....	17
4.4	Set up the network path in the scanning software.....	19
4.5	Copy the calibration data folder for viewer clients .....	19
4.6	Install Noah as a server.....	20
<b>5</b>	<b>Set up the Noah client .....</b>	<b>21</b>
5.1	Overview .....	21
5.2	Install Noah as a client .....	21
5.3	Register the client PC on the Noah server .....	22
5.4	Set up the scanning software .....	23
5.4.1	Set up the scanning software as a viewer (without a scanner) .....	23
5.4.2	Set up the scanning software as a scanning workstation.....	26

# 1 About this manual

**Please save this operating manual, pass it on with the product and replace it with a new version after performing an upgrade.**

## Symbols and highlighting of important information

▷ Action step

✓ Result



Cross reference to pages (with hyperlink). Back to the starting point: Use the page navigation of the PDF reader ("Previous View", "Back").

**Hyperlink**  (in this PDF file or external)



Paid addition or module



Variant, depending on the scanner



Mouse operation, the key to be pressed is highlighted



### TIP

Helpful advice



Product manufacturer

## Software controls

**OK**

Button

**Name**

Fields

"Name"

Icon

**File | New**

Menu items

Name.txt

File and path names

## Illustrations

The device and software images may differ from the customer's systems. For example, the screenshots display no customer data.

## Units of measurement and numbers

Units of measurement      Units legally in force in Germany  
International System of Units (SI)

Numbers      Decimal system with decimal places

Measurement	Unit	Abbreviation
Mass/weight	Kilogram	kg
	Gram	g
Length	Metre	m
	Centimetre	cm
	Millimetre	mm
	Micrometre	µm
Angle	Degree	°
Time	Hour	h
	Minute	m
	Second	s
Electrical power	Watt	W
Electrical voltage	Volt	V
	Alternating current	AC
Electrical frequency	Hertz	Hz
	Gigahertz	Ghz
Electrical current	Ampere	A
Protection class	International Protection	IP
		1 <sup>st</sup> digit: solids protection, 2 <sup>nd</sup> digit: fluids protection
Temperature	Degree Celsius	°C
Memory (PC)	Random-Access Memory	RAM
Data volume	Megabyte	MB
	Gigabyte	GB
CAD data format	Standard Triangulation Language	STL
	American Standard Code for Information Interchange	ASCII
	Mesh	MSH
	Point Cloud Measurement	PCM
Picture element	Pixel	px (monitor)
		dpi (print)
	Megapixel	Mpx

## Warnings

Warnings provide information on:

- Possible personal injuries,
- Possible damages to objects,
- Risk avoidance.

## Warning levels

### NOTICE



Material damages

### CAUTION



Minor injuries

### WARNING



Minor injuries

### DANGER



Death or severe injuries

## Safety

Please follow the safety instructions:

Operating manual  
For your safety

- for smart optics audiology scanners,
- for Noah.

## 2 smart optics interface with Noah

### 2.1 Introduction

This manual is aimed at audiology, hearing technology and hearing acoustics facilities and companies which:

- Use or wish to use Noah from HIMSA,
- Scan auditory canal impressions with smart optics 3D scanners,
- Wish to manage scans through Noah.

This manual will show you how to set up the interface with Noah.



Operating manual  
Chapter 10

#### TIP

Information on how to use the interface can be found in the operating manual of smart optics audiology scanners.

- 10.1 Noah interface setup
- 10.2 Scanning with Noah
- 10.3 Viewing, editing and exporting scans from Noah

### 2.2 About the interface

#### Integration

The interface with Noah is:

- Integrated into the smart optics software,
- can be used without further installation or activation.

#### Functionality

The Noah Patient Browser fulfils the following functions:

- Patient documentation,
- Starting point of scans done with smart optics audiology scanners,
- Collection of scan actions, etc.

## 2.3 About Noah

### Manufacturer

Hearing Instrument Manufacturers' Software Association (HIMSA)  
[www.himsa.com](http://www.himsa.com)

HIMSA provides detailed information about the following concerning Noah:

- General product information
- First time installation and setup
- Troubleshooting

### Online sources

Please pay special attention to the following information before installing Noah and setting up the interface.

- Product information:  
<https://www.himsa.com/products/all-about-noah-system-4/>
- Knowledge base:  
<https://www.himsa.com/support/noah-4-knowledge-base/>
- Preparation for installation:  
<https://www.himsa.com/support/noah-4-knowledge-base/preparing/>
- Installation:  
<https://www.himsa.com/support/noah-4-knowledge-base/installation-guidelines/>
- Licence:  
<https://www.himsa.com/support/noah-4-knowledge-base/installation-guidelines/noah-licensing-and-related-issues/>
- Troubleshooting:  
<https://www.himsa.com/support/noah-4-knowledge-base/noah-4-troubleshooting/>
- Tutorials:  
<https://www.himsa.com/support/noah-4-knowledge-base/the-learning-center-2/>

### Sales

Certified distributors

Website: [About HIMSA](#) ▼ [HIMSA Distributors: Worldwide](#)



## 2.4 Prerequisites

### 2.4.1 Qualification

To set up a Noah server, Noah clients and scanners, you must have knowledge of:

- Windows administration,
- Noah installation and setup,
- Commissioning of smart optics audiology scanners,
- Installation and setup of the smart optics scanning software (currently aural Scan).

### 2.4.2 Rights, licences, hardware

For the subsequent tasks you will need:

- ☐ Administration rights on all PCs
- ☐ Noah server license
- ☐ Noah client license for each:
  - Scanner workstation
  - Scan data viewer
- ☐ For each scanner workstation:
  - Audiology scanner
  - Scanning software
  - Calibration data
- ☐ For each scan data viewer:
  - Scanning software (license-free)
  - Calibration data (of a scanner workstation)

### 2.4.3 Software compatibility

Software	Version	Where to find the version info
Noah	4.8 or higher	— Name of the Noah installation file, e.g. Noah_System_4.8.0.3805.exe
Scanning software	2.5.06 or higher	— Label on the installation data carrier
aural Scan	3.0 or higher	— Properties of the setup file: aural Scan.exe dsProduction.exe duoscan.exe monoscan.exe

Right click, field **Description:**

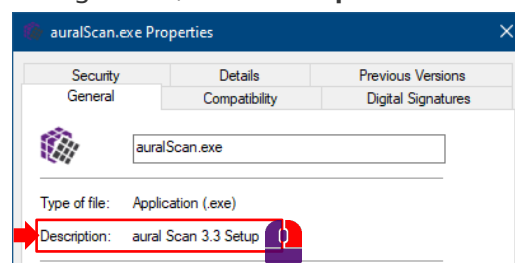

aural Scan 3.0 or higher

aural Scan info dialogue:



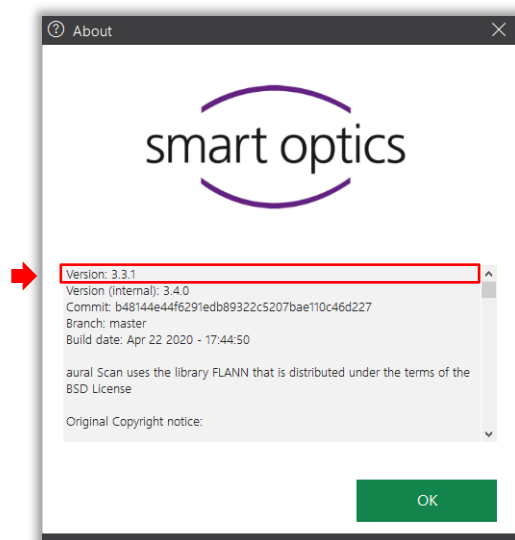





 Menu  Info



### 3 System configuration examples

#### Example 1

##### Key

-  Noah server
-  Noah client
-  Noah database
-  Data flow
-  Scanner workstation
-  Scan data viewer
-  Scan data storage
-  Device connection

PC 1 = Noah server\*

PC 2 = Noah client\*\*



#### Example 2

PC 1 = Noah server\*

PC 2 = Noah client\*\*

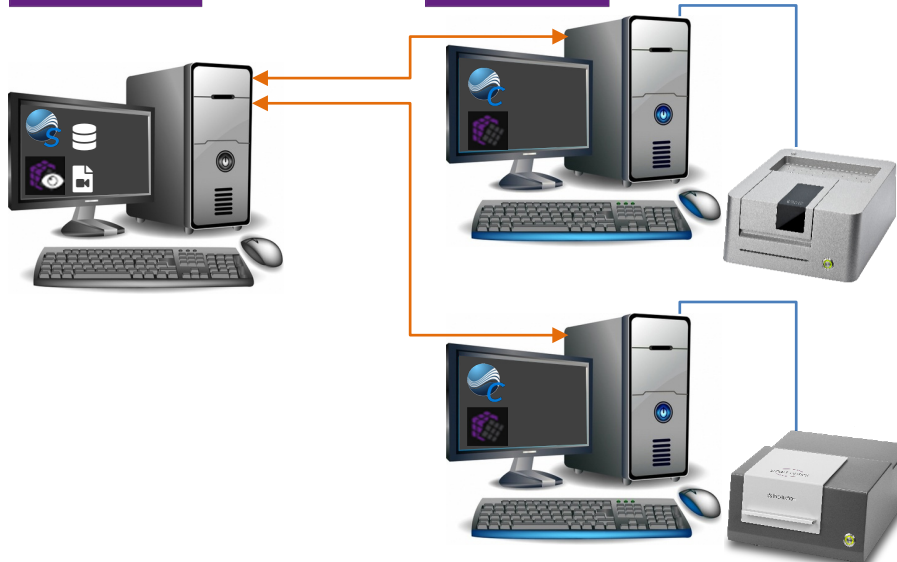









\* Freely selectable audiology scanner

\*\* Additional client PCs possible

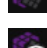
## Example 3

### Key

-  Noah server
-  Noah client
-  Noah database
-  Data flow
-  Scanner workstation
-  Scan data viewer
-  Scan data storage
-  Device connection

PC 1 = Noah server\*

PC 2 = Noah client\*\*

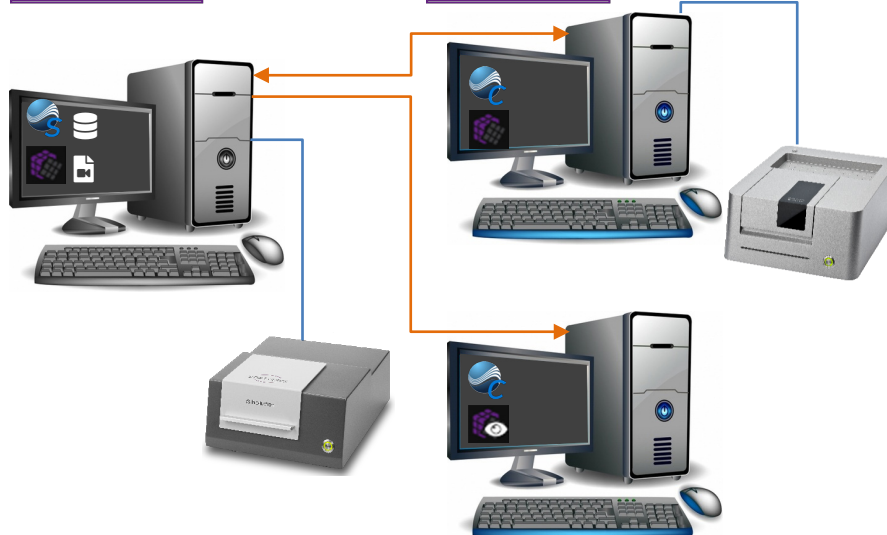

## Example 4

PC 1 = Noah server

PC 2 = Noah client\* \*\*

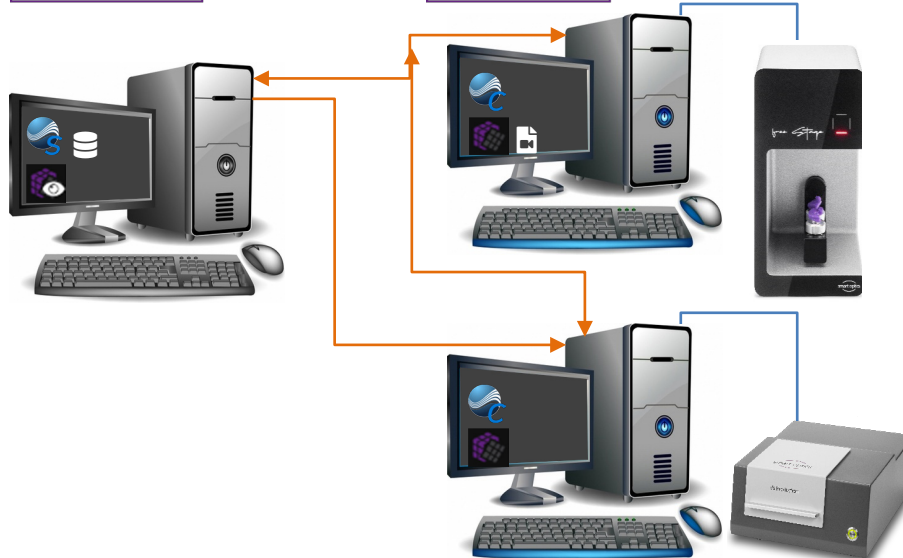

\* Freely selectable audiology scanner

\*\* Additional client PCs possible

## 4 Set up the Noah server

### 4.1 Overview



#### Before you start

- ▷ Plan your system configuration (→ [Examples 1-4](#)).

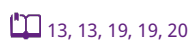

#### Respect the task sequence

- ☐ Install the scanning software
- ☐ Share the scan data folder as a network path
- ☐ Set up the network path as work folder
- ☐ Copy the calibration data folder for viewer clients (optional)
- ☐ Install Noah as a server

### 4.2 Install the scanning software



Audiology scanners  
operating manual  
[Chapters 5.3, 6](#)

- ▷ Before installing, connect a scanner to the Noah server.
- ▷ Install the scanning software.
- ▷ Load the scanner's calibration data.
- ▷ Open the scanning software and close it again.
- ✓ The folder `C:/Scans` (scan data folder) will be created.



#### TIP

If the Noah server is not intended to be a scanning workstation, you can remove the scanner again.

### 4.3 Share the scan data folder as a network path

The scan data folder on PC 1 (Noah server):

- Should save the scan data of all scanning workstations,
- must be shared as a network path for client access.



Example 4

#### TIP

Setup of the central scan data folder on a PC 2 (Noah client).

## 4.3.1 Folder sharing (part 1: sharing)

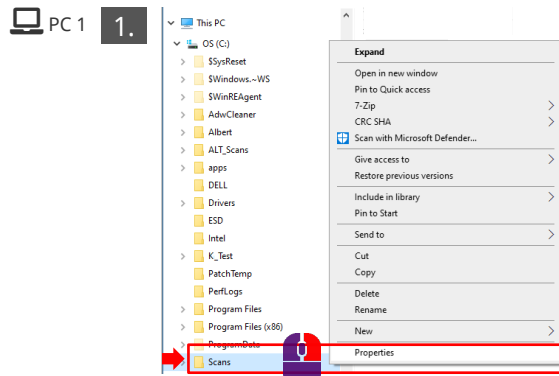
**Open the properties of C:\Scans**

- ▷ In Windows Explorer, right-click the folder **C: \Scans**.
- ▷ Select **Properties**, to open the dialogue.

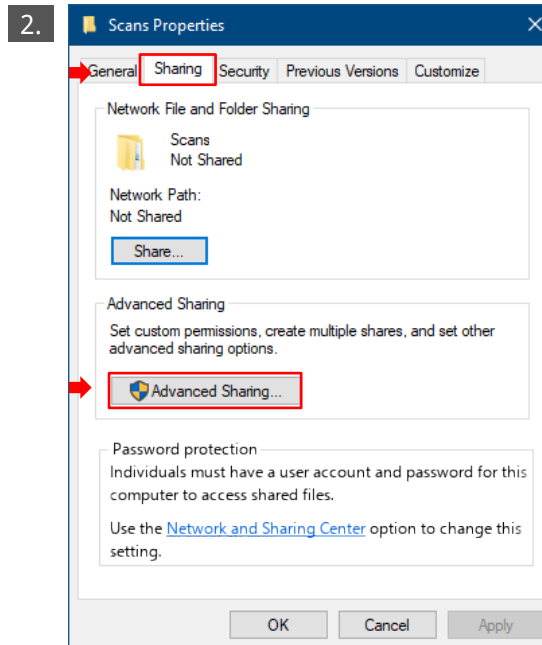
**Open the advanced sharing of C:\Scans**

- ▷ Open the tab **Sharing**.
- ▷ Click on **Advanced Sharing ...** to open the dialogue.

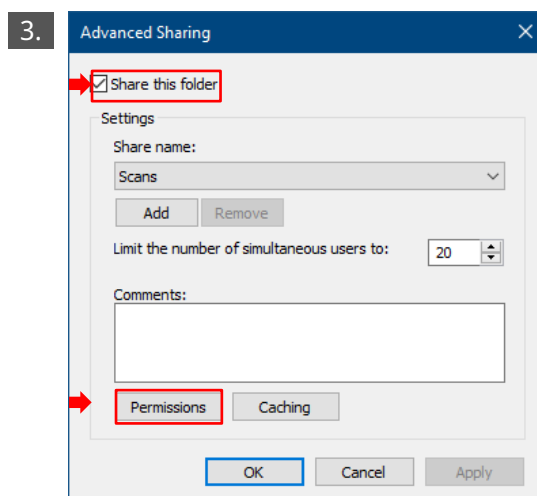
**Open permissions for folder "C:\Scans"**

- ▷ Check **Share this folder**.
- ▷ Click on **Permissions ...** to open the dialogue.



4.

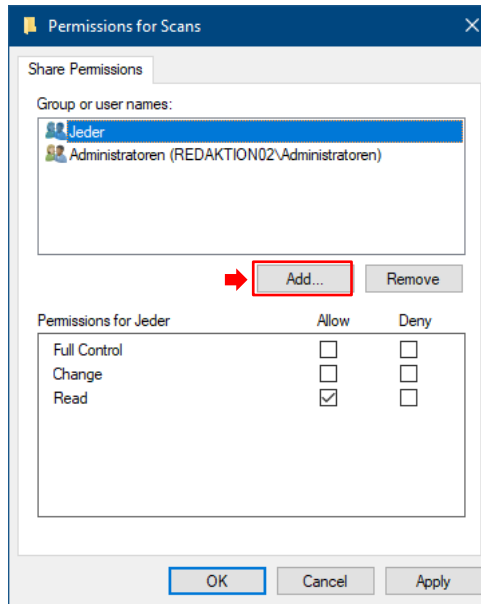

Add users/groups to permissions

- Click on **Add...** to open the dialogue.

5.

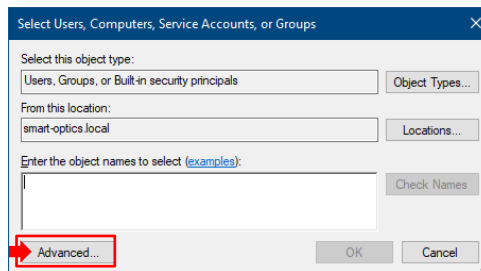

Expand the "Select users or groups" dialogue

- Click on **Advanced ...** to open the dialogue.

6.

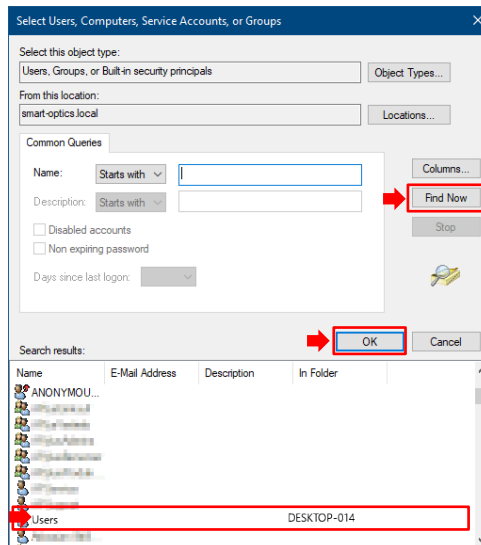

Search for the "Users" group

- Click on **Search now.**
- Select **Users** in **Search results.**
- Click **OK** (twice).
- ✓ The group **Users** will be displayed in the dialogue box **Permissions for "Scans"**.

PC 1 7.

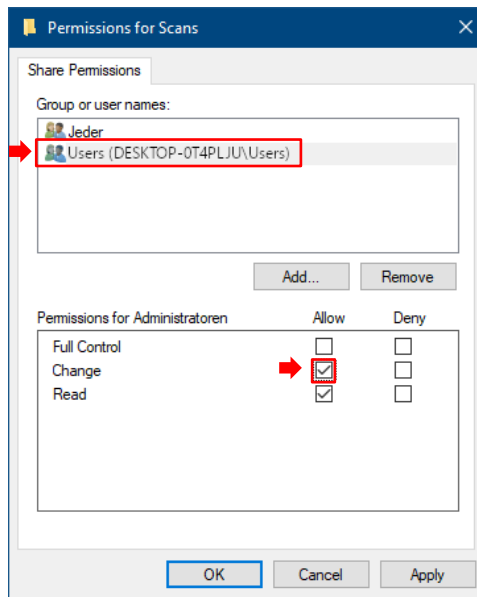

Assign the permission “Change” to the group “Users”

- ▷ Select the group **Users**.
- ▷ Under **Permissions for Users** check **Change** in the column **Allow**.
- ▷ Click on **OK**.
- ✓ The permission for the group “Users” is transferred to the tab **Share** under **Scans Properties**.

## Client setup information

21

To perform later tasks on PC 2, you will need:

- Username and password of the server user who shares the folder,
- The network path to PC 1.

PC 1

Strg + C

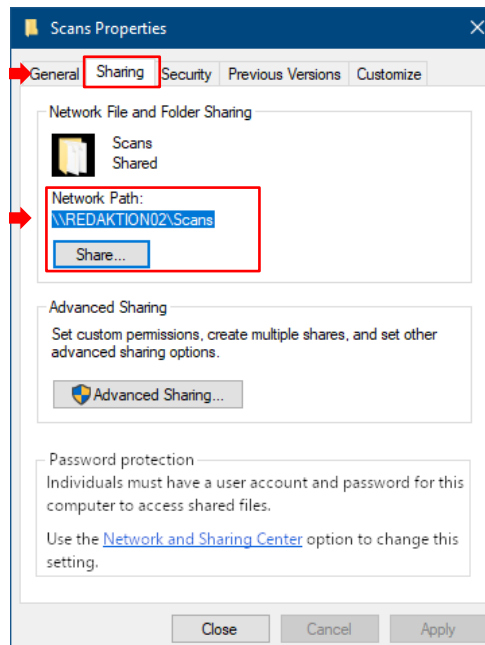

Copy the network path

- ▷ Select the name of the server folder \\ [PC\_1] \Scans under **Network Path**.
- ▷ Make a note of the network path. Copy the path to the clipboard.
- ✓ You need the path/content of the clipboard on PC 2 (Noah client) to:
  - Scanning software [settings](#),
  - [Network registration](#) (Client → Server).



## 4.3.2 Folder sharing (part 2: security)

**TIP**

The steps are almost the same as in [Part 1: sharing](#).



PC 1

1.

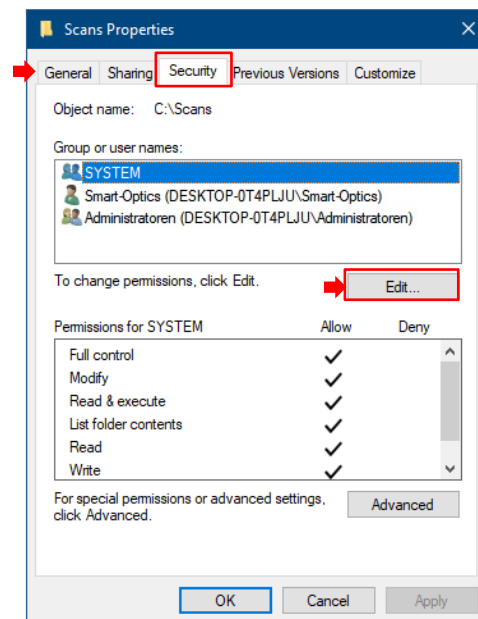
**Edit permissions for “C:\Scans”**

- ▷ In the dialogue box **Scans Properties**, go to the **Security** tab.
- ▷ Click on **Edit...** to open the dialogue.

2.

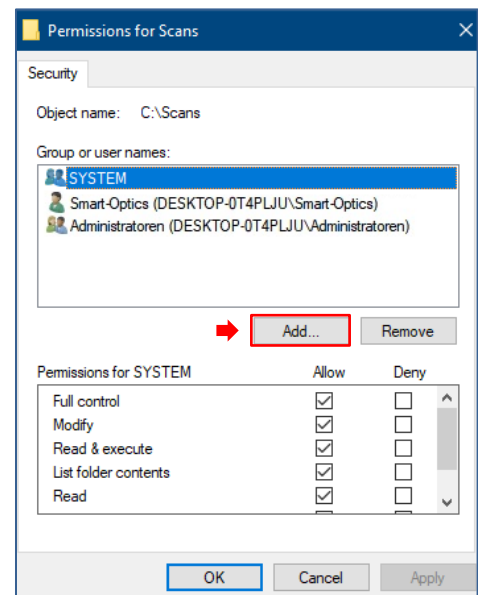
**Add permissions for “C:\Scans”**

- ▷ Click on **Add...** to open the dialogue.



3.

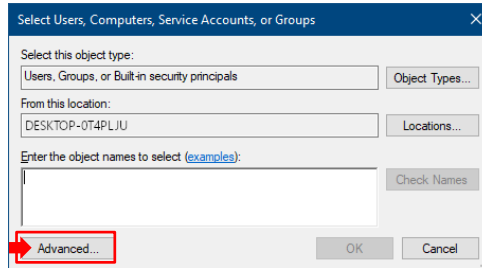

Expand the “Select users or groups” dialogue

- Click on **Advanced ...** to open the dialogue.

4.

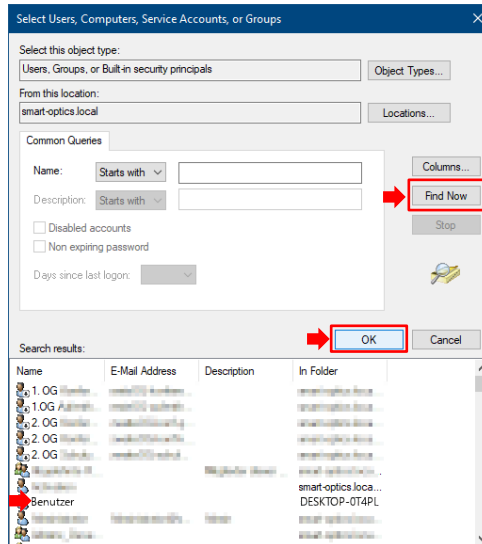

Search for the “Users” group

- Click on **Search now.**
- Check **Users** in **Search results.**
- Click **OK** (twice).
- ✓ The permission for the group “Users” is transferred to the tab **Security** under **Scans Properties.**

5.

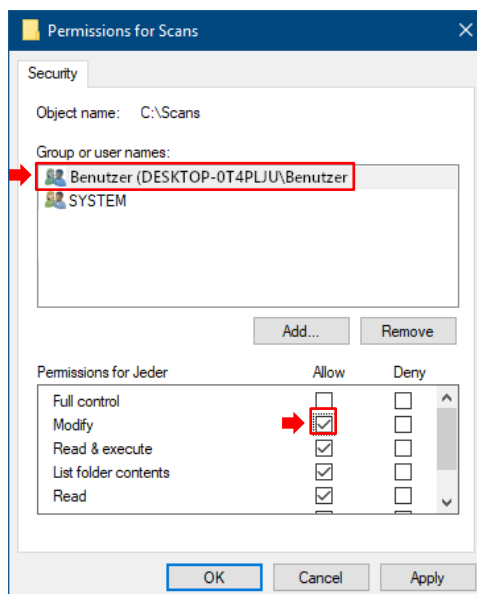

Assign the permission “Change” to the group “Users”

- Select the group **Users.**
- Under **Permissions for Users** check **Change** in the column **Allow.**
- Click on **OK.**
- ✓ The permission for the group “Users” is transferred to the tab **Share** under **Properties of Scans.**

- Close the dialogue box **Scans Properties** by clicking on **OK.**
- ✓ The installation and folder sharing have been completed.

## 4.4 Set up the network path in the scanning software



- ▷ Start the scanning software on the Noah server (in this case: aural Scan).

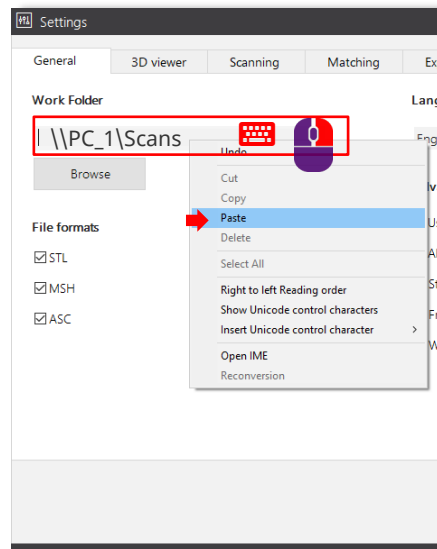

- ▷ Open **Settings**.



- ▷ In the field **Work Folder**, enter the network path to the shared folder \\ [PC\_1] \Scans (contents of the clipboard).
- ▷ Save the settings and close the scanning software.

**In older scanning software:**

Settings: Tab **Installation**, Field **Export Folder**

- ✓ The group "Users" can save scan data in the central scan data folder.

## 4.5 Copy the calibration data folder for viewer clients



Paths:  
aural Scan  
Older scanning  
software

These steps are necessary if you wish to set up viewer clients (→ [Examples 1-4](#), not for scanning workstations).

- ▷ Copy the calibration data folder from the data folder:

C:\Program Files (x86)\3D-Scanner\aural Scan\data\

C:\Program Files (x86)\3D-Scanner\[scanner name]\data

Folder name (structure): SO-202XX.XX-XX-XXX

- ▷ Paste under C:\Scans\ (shared scan data folder).

- ✓ Client PCs can use the scanning software as viewer.

## 4.6 Install Noah as a server

PC 1

Himsa Information:  
[www.himsa.com/himsa\\_download/noah-system-download/](http://www.himsa.com/himsa_download/noah-system-download/)

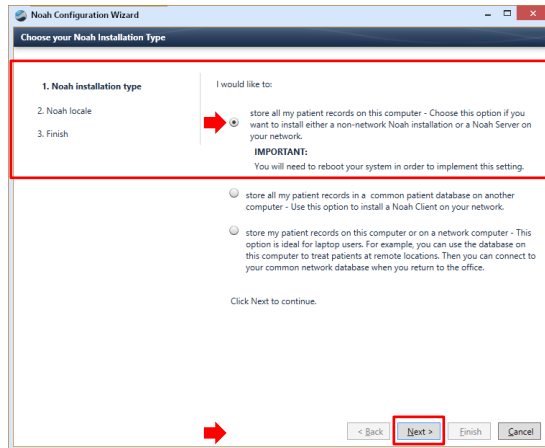

- ▷ Install Noah.
- ▷ Select the installation option “Server” in the configuration wizard.
- ▷ Follow the instructions of the wizard.

- ▷ Establish a connection between Noah and the scanning software by opening and closing in the order below:
  - Start Noah,
  - Minimize the software window,
  - Start the scanning software,
  - Close the scanning software,
  - Close Noah,
- ▷ Restart the server PC.
- ✓ Noah will have been installed as Noah server and the scanning software will be ready for use.

PC 1

**The Noah server must always be switched on for clients to access it.  
 Noah works in the background.**

## 5 Set up the Noah client

### 5.1 Overview

#### Prerequisites

- ☐ The Noah server is installed and set up.
- ☐ Client setup information is available:
  - Username and password of the server user,
  - The network path to PC 1 (Noah server).

 16

**The server user must have a password to log on to the network (not a “blank password”).**

#### Respect the task sequence

 21, 22, 23, 26

- ☐ Install Noah as a Client
- ☐ Register the client PC on the Noah server
- ☐ Set up Noah clients as:
  - Viewer (without a scanner)
 OR
  - Scanning workstation

### 5.2 Install Noah as a client

 PC 2

Himsa Information:  
[www.himsa.com/himsa\\_download/noah-system-download/](http://www.himsa.com/himsa_download/noah-system-download/)

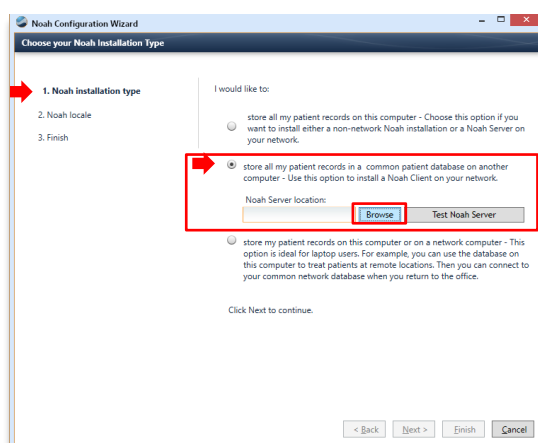

- ▷ Install Noah.
- ▷ Select the installation option “Client” in the configuration wizard.
- ▷ To connect the Noah client to the Noah server, click **Browse**.
- ✓ A dialogue box to establish a server connection will open.

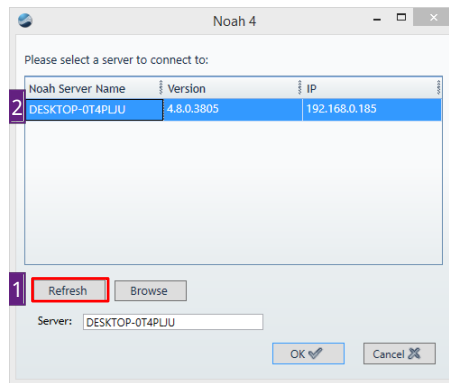

- ▷ Click **Update**.
- ▷ Select PC 1 (Noah server – network name)
- ▷ Click on **OK**.
- ▷ Follow the instructions of the wizard.



- ✓ The Noah client will have been:
  - Installed,
  - Connected to the Noah server.

## 5.3 Register the client PC on the Noah server



- ▷ On the client PC, open:
  - Windows Explorer,
  - The section **Network**.

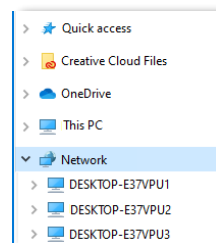

- ▷ Click on [ **PC 1** ] (Network name).
- ▷ Log in as a server user (username + password).
- ✓ Windows Explorer will now display the content of the Noah server.



## 5.4 Set up the scanning software

 11, 23, 26

- ▷ Select an option according to your system configuration (→ [Examples 1-4](#)):
  - [Set up the scanning software as a viewer \(without a scanner\)](#)
  - [Set up the scanning software as a scanning workstation](#)

### 5.4.1 Set up the scanning software as a viewer (without a scanner)

 PC 2  
Audiology scanners  
operating manual  
[Chapter 6](#)

#### Install the scanning software

- ▷ Install the scanning software:
  - Without a scanner,
  - Without calibration data.



#### Copy the calibration data folder from the server

- ▷ Copy the calibration data folder from the Noah server to the clipboard.

#### Folder name (structure)

SO-202XX.XX-XX-XXX

#### Path

Paths:  
aural Scan  
Older scanning  
software

\\[PC1]\Program Files (x86)\3D-Scanner\aural Scan\data

\\[PC1]\Program Files (x86)\3D-Scanner\[scanner name]\data

- ▷ Paste to PC 2 (Noah client) under:

C:\Program Files (x86)\3D-Scanner\aural Scan\data\

C:\Program Files (x86)\3D-Scanner\[scanner name]\data

- ✓ The Noah client will have the calibration data of the Noah server.

#### Create and edit custom settings file

##### 1. To create

 PC 2

- ▷ Start the scanning software.
- ✓ The file `Settings.xml` for custom settings will be created.



#### TIP

The below error message will be displayed because no scanner is connected:

**Couldn't connect to the scanner.**

Close and ignore the message.

## 2. Copy the network path



- ▷ Open:
  - Windows Explorer,
  - The section **Network**.

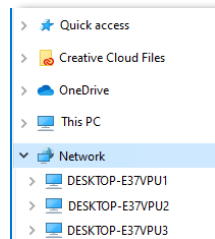

- ▷ Open the shared scan data folder on PC 1 (Noah server):

Scan data folder

\\[PC 1]\Scans



- ▷ Copy the network path from the address bar.
- ▷ Open the local folder AppData (PC 2 -Noah client) by:
  - Writing "% appdata%",
  - Pressing "ENTER".



### TIP

AppData is the local roaming folder (usually hidden).

- ▷ Open the subfolder:

Paths:  
aural Scan  
Older scanning  
software

\Roaming\3D-Scanner\**aural Scan**\config

\Roaming\3D-Scanner\[**scanner name**]\config\

### Example:

C:\Users\Michael Smith\AppData\Roaming\3D-Scanner\**aural Scan**\config\

C:\Users\Michael Smith\AppData\Roaming\3D-Scanner\**duo Scan**\config\



### 3. To edit the custom settings file

- ▷ Open the file `Settings.xml` to edit it (Windows Notepad).

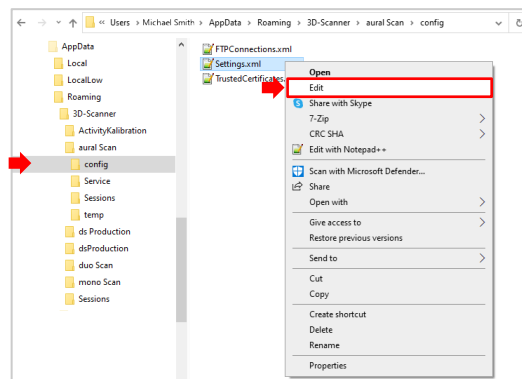

#### TIP

The file `Settings.xml` in the folder `data` is for the standard settings. Please do not modify it!

- ▷ Select **Edit | Find**.
- ▷ Look for “Directory Value” in the group **Export** (twice).
- ▷ Replace the path `C:\Scans` with the copied network path.



**Example**  
`\\DESKTOP-0T4PLJU\Scans`

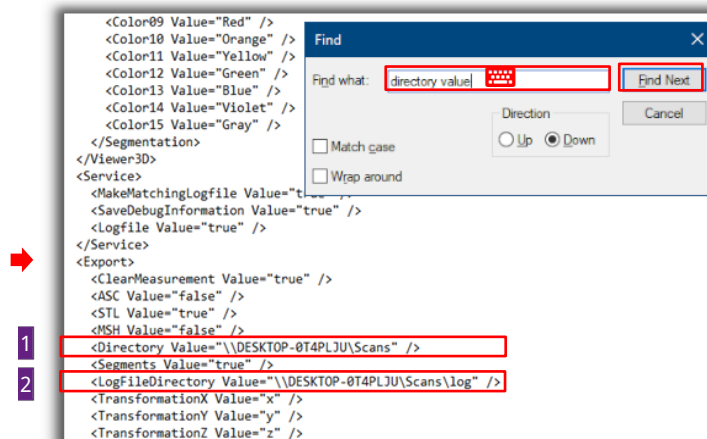

- ▷ Replace the path `C:\Scans` in the same way with the value “LogFileDirectory”. The `\log` part must remain unchanged.
- ▷ Save the file `Settings.xml`.
- ▷ Close Notepad.
- ✓ The scanning software on PC 2 (Noah client) will recognize the scan data folder on PC 1 (Noah server).

Audiology scanners  
operating manual  
Chapter 10.3

### Results

- The scanning software can be used on the PC 2 (Noah client) to view scans (without a scanner).
- PC 1 (Noah server) and PC 2 (Noah client) have access to:
  - The Noah Database,
  - The scan data folder.

### Restrictions

Without a scanner:

- The scanning software does not start for processing,
- The smart optics button in the Noah Patient Browser has no function (→ camera error message).

## 5.4.2 Set up the scanning software as a scanning workstation

 PC 2  
Audiology scanners  
operating manual  
Chapters 5.3, 6

### Install the scanning software

- ▷ Connect the scanner.
- ▷ Install the scanning software.
- ▷ Load the scanner's calibration data.

 PC 2

### Enter the shared scan data folder into the scanning software

- ▷ Open:
  - Windows Explorer,
  - The section **Network**.

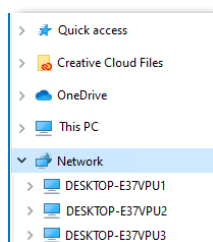

- ▷ Open the shared scan data folder on PC 1 (Noah server):  
\\ [PC 1] \Scans

Scan data folder



- ▷ Copy the network path from the address bar.
- ▷ Start the local scanning software (in this case: aural Scan).

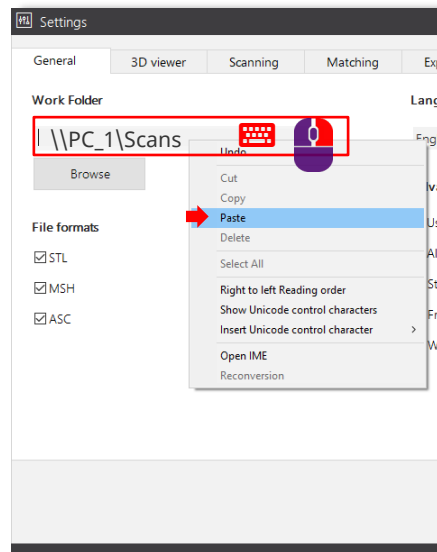

#### ▷ Open **Settings**



- ▷ In the field **Work Folder**, enter the network path to the shared server folder (contents of the clipboard).
- ▷ Save the settings and close the scanning software.

#### **In older scanning software:**

Settings: Tab **Installation**,  
Field **Export Folder**

- ✓ The scanning software on PC 2 (Noah client) will recognize the work folder on PC 1 (Noah server). The scan data will be saved here.

### Connect Noah and the scanning software



PC 2

- ▷ Establish a connection between Noah and the scanning software by opening and closing in the order below:
  - Start Noah (minimize the software window),
  - Start the scanning software,
  - Close the scanning software,
  - Close Noah.
- ▷ Start Noah again.
- ✓ PC 2 (Noah client) and PC 1 (Noah server) will have been connected.

### Results

- ☐ PC 1 (Noah server) and PC 2 (Noah client) can:
  - Scan,
  - Save data on PC 1 (Noah server) in the shared folder \\PC\_1\Scans,
  - Save data in the Noah database.
- ☐ A subfolder `Noah` will be automatically created.



## Manufacturer

smart optics Sensortechnik GmbH  
Lise-Meitner-Allee 10  
D-44801 Bochum, Germany



+49 (0) 234 / 29 828-0



+49 (0) 234 / 29 828-20



info@smartoptics.de



sales@smartoptics.de



support@smartoptics.de



ID: SO-audio-SIEA-20246/20252/20263-EN

[www.smartoptics.de](http://www.smartoptics.de)

Audiology Online Shop: [smartoptics.shop](http://smartoptics.shop)

